

### 1. Register Master Fobs

- A. Push the programming button on the back of the door station. Release this button whenever the station makes an audible beep. Please refer to image (1).
- B. Press and hold the doorbell button on the front of the station. Do not release the button until the station beeps twice. Please refer to image (2).
- C. Whichever fob is chosen to be the Master fob will at this point be held up to the center-most part of the door station faceplate. When held close enough to the front of the unit, the station will give another audible beep. This indicates that the station successfully programmed the Master fob. Please refer to image (3).
- D. Exit programming by pressing the button on the rear of the station a second time. Again, refer to image (1).

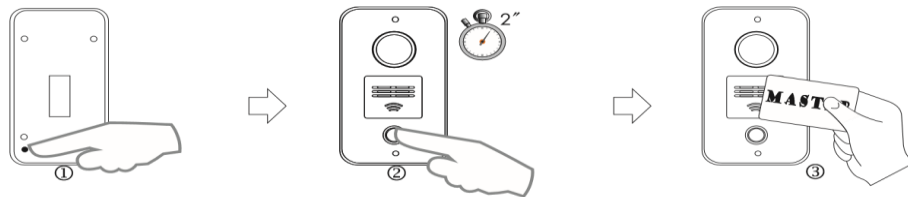

### 2. Register User Fobs

- A. Place the Master fob up to the face of the door station. You will hear an audible beep when the station effectively enters the registration mode. Please refer to image (1) below.
- B. Whichever fob is going to be the User fob will be placed in front of the station now. Please refer to image (2) below. Another beep will indicate that it has been registered successfully.
- C. To exit the programming mode, place the Master fob up the face of the station again.

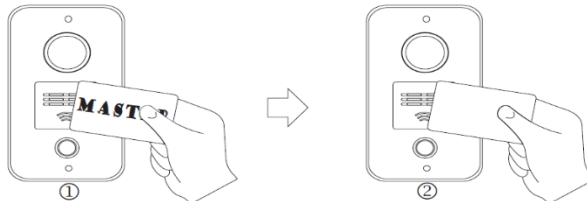

### 3. Cancel Fobs

- A. Place the Master fob up to the face of the door station. You will then hear an audible beep. Please refer to image (1) below.
- B. Press and hold the doorbell button. Please refer to image (2) below. Do not release the button until you hear a beep signifying a successful reset. At this point, all Master and User cards have been canceled.

